

General Location Map

Printed on: September 29, 2017

Account No: 230061000, 230301000, 230067000
 Owner: STOREDAHL PROPERTIES LLC
 Address: 2233 TALLEY WAY
 C/S/Z: KELSO, WA 98626

 Subject Property Location

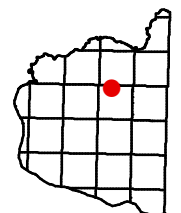

Geographic Information System

1:24,000

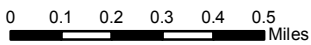

Information shown on this map was collected from several sources. Clark County accepts no responsibility for any inaccuracies that may be present.

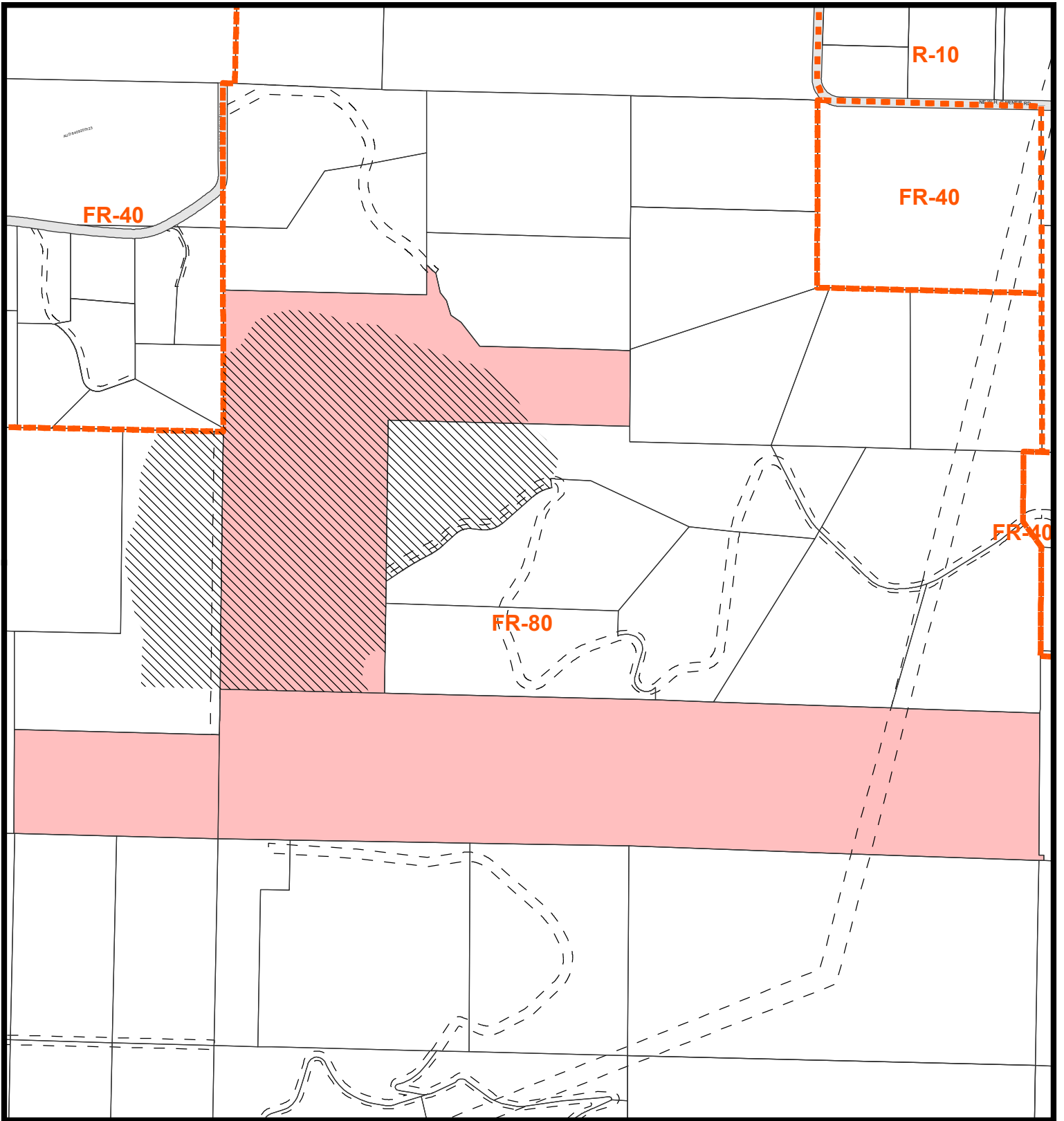

Geographic Information System

1:10,300

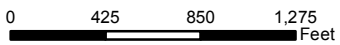

Zoning Designation

Account No: 230061000, 230301000, 230067000

Owner: STOREDAHL PROPERTIES LLC

Address: 2233 TALLEY WAY

C/S/Z: KELSO, WA 98626

- Subject Parcel
- Public Road
- Transportation or Major Utility Easement
- Zoning Boundary
- Urban Holding - 10 (UH-10)
- Urban Holding - 20 (UH-20)
- Urban Holding - 40 (UH-40)
- Surface Mining Overlay District

Printed on: September 29, 2017

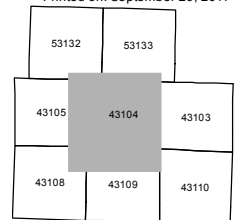

Information shown on this map was collected from several sources. Clark County accepts no responsibility for any inaccuracies that may be present.

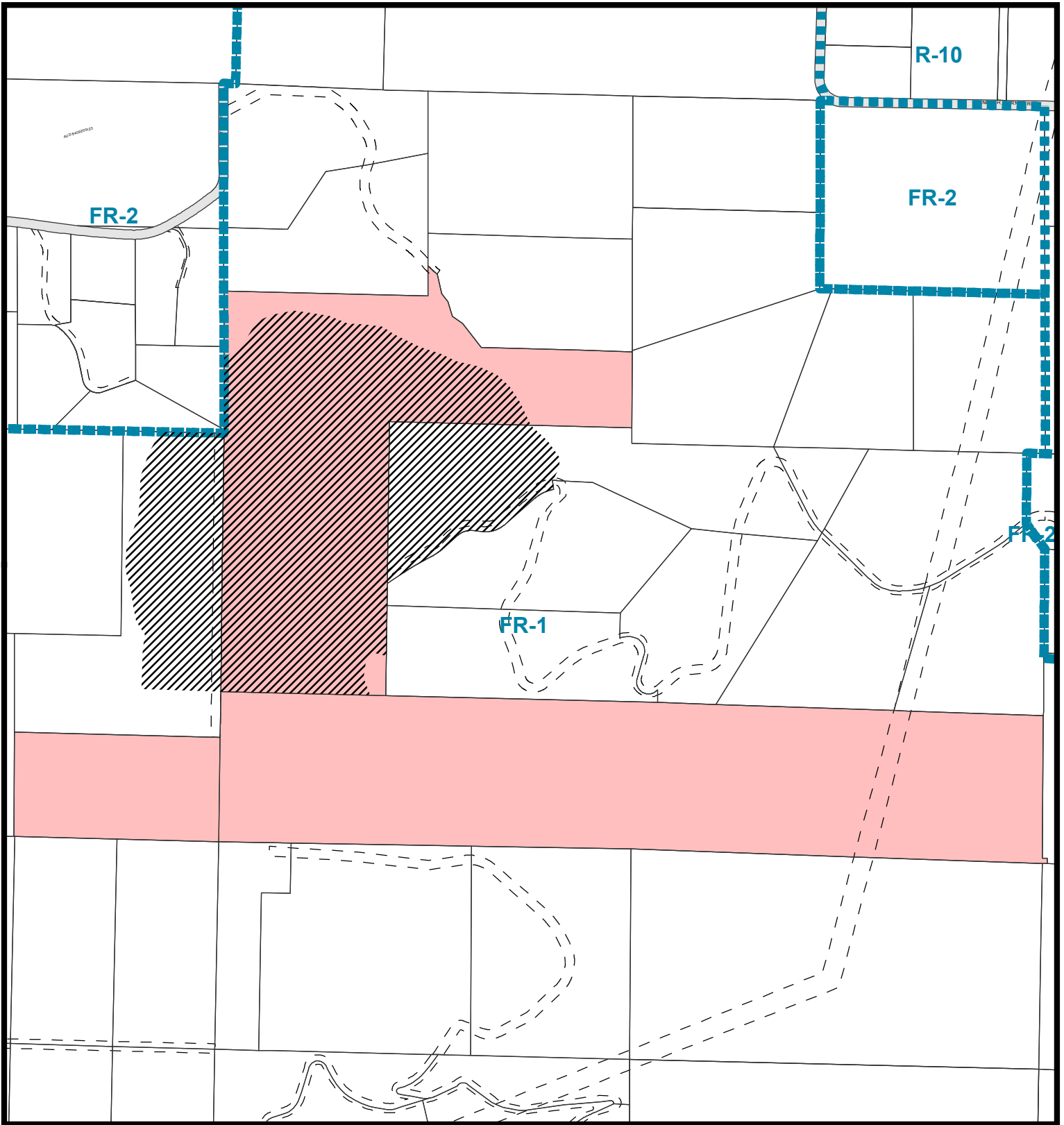

Geographic Information System
1:10,300

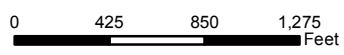

Developer's GIS Packet Page 7 of 18

Comprehensive Plan Designation

Account No: 230061000, 230301000, 230067000
 Owner: STOREDAHL PROPERTIES LLC
 Address: 2233 TALLEY WAY
 C/S/Z: KELSO, WA 98626

- Subject Parcel
- Public Road
- Transportation or Major Utility Easement
- Comprehensive Plan Boundary
- Urban Reserve
- Industrial Reserve
- Railroad Industrial Reserve
- Mining
- Rural Center Mixed Use
- Columbia River Gorge Scenic Area

Printed on: September 29, 2017

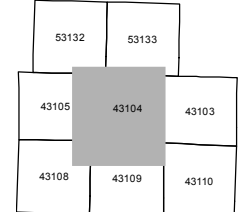

Information shown on this map was collected from several sources. Clark County accepts no responsibility for any inaccuracies that may be present.