







File # CPZ2019-00004, SN 210776000

T4N R1E Sec 07

Preliminary Land Division

Owner: GROTH DAVID WILLIAM & GROTH CHERYL

-  Subject Property
-  Zoning Boundary
-  Mining Combining District
-  Contingent Zoning
-  Urban Holding-10
-  Urban Holding-20



Information shown on this map was collected from several sources. Clark County accepts no responsibility for any inaccuracies that may be present.



File # CPZ2019-00004, SN 210776000
 T4N R1E Sec 07
 Preliminary Land Division

Owner: GROTH DAVID WILLIAM & GROTH CHERYL

- Subject Property Location
- Comp Plan Boundary
- Mining
- Industrial Reserve
- Columbia River Gorge N.S.A.



Information shown on this map was collected from several sources. Clark County accepts no responsibility for any inaccuracies that may be present.

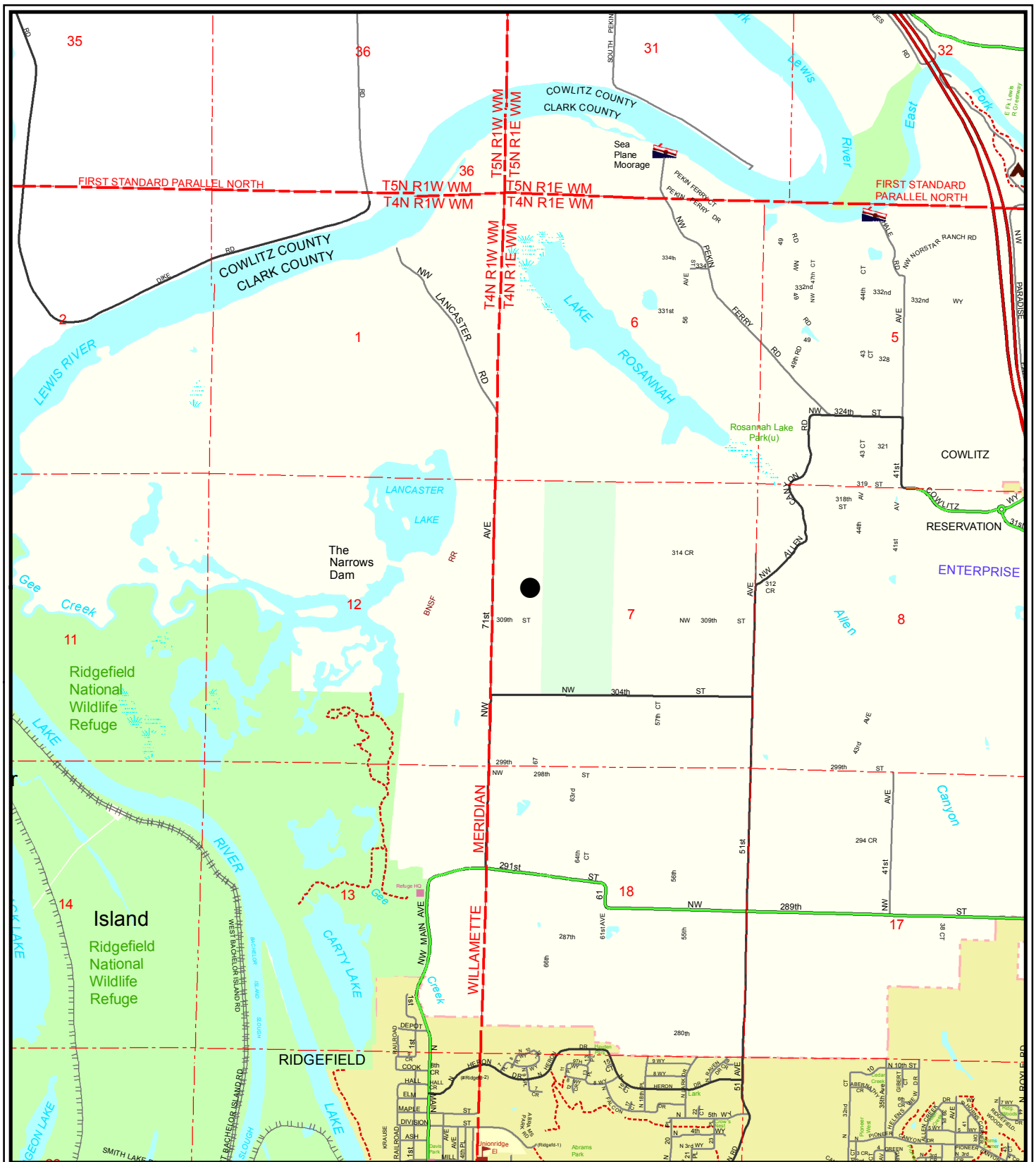

File # CPZ2019-00004, SN 210776000

T4N R1E Sec 07

Preliminary Land Division

Owner: GROTH DAVID WILLIAM & GROTH CHERYL I

● Subject Property Location



Information shown on this map was collected from several sources. Clark County accepts no responsibility for any inaccuracies that may be present.